



EMF MEASUREMENT DATA

DATE (MM/DD/YY)

07/01/13

TIME (H:M)

1p.m.

A Sempra Energy utility™

CUSTOMER INFORMATION

 Residential Commercial Other School

SDG&E PERSONNEL

NAME	Eric Feeley - Bellamonte Charter School			NAME	Josh M.
ADDRESS	1737 W. Vista Way			DEPT.	Marlynn P.
CITY	Vista	PHONE	858.226.1021	PHONE	619.592.1521

MAGNETIC FIELDS ARE CREATED BY THE MOVEMENT OF ELECTRICITY (CURRENT) AND WILL VARY DEPENDING ON THE AMOUNT OF ELECTRICITY BEING USED AT ANY GIVEN TIME. THE MEASUREMENTS RECORDED ON THIS FORM REPRESENT ONLY THE FIELD LEVELS AT THE DATE AND TIME OF THIS MEASUREMENT AND MAY REFLECT A VARIETY OF SOURCES. THESE SOURCES MAY INCLUDE NOT ONLY POWER LINES, BUT HOME APPLIANCES, HOUSE WIRING AND PLUMBING.

SAN DIEGO GAS & ELECTRIC PROVIDES MEASUREMENTS UPON REQUEST AS A CUSTOMER SERVICE, ALTHOUGH THE CURRENT HEALTH SCIENCE DATA DO NOT PROVIDE A BASIS FOR INTERPRETING THE SIGNIFICANCE OF THESE MEASUREMENTS.

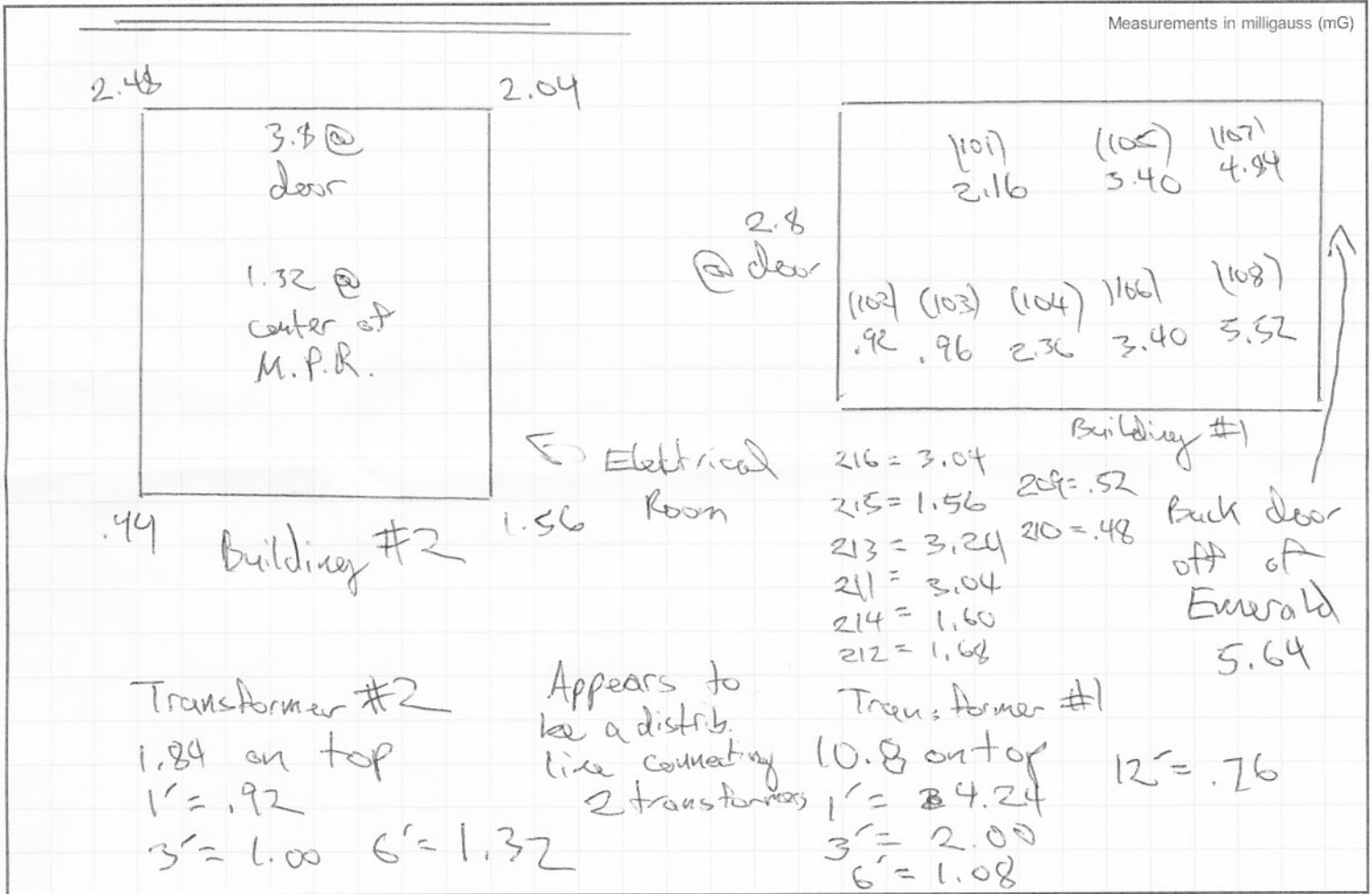

INDOOR (mG)

OUTDOOR (mG)

OPTIONAL MEASUREMENTS (mG)

ROOM OR LOCATION	CENTER
(A) FRONT DOOR	
(B) FAMILY/LIVING ROOM	
(C) KITCHEN	
(D) BEDROOM 1	
(E) BEDROOM 2	
(F) BEDROOM 3	
(G) BEDROOM 4	
(H)	
AVERAGE	

(I) CORNER 1	
(J) CORNER 2	
(K) CORNER 3	
(L) CORNER 4	
AVERAGE	
NOTES:	

APPLIANCE	1 INCH	1 FOOT
OTHER		